

各部名稱 Main Parts

無線 無刷 吸塵 機
Cordless Brushless Vacuum Cleaner

Batus

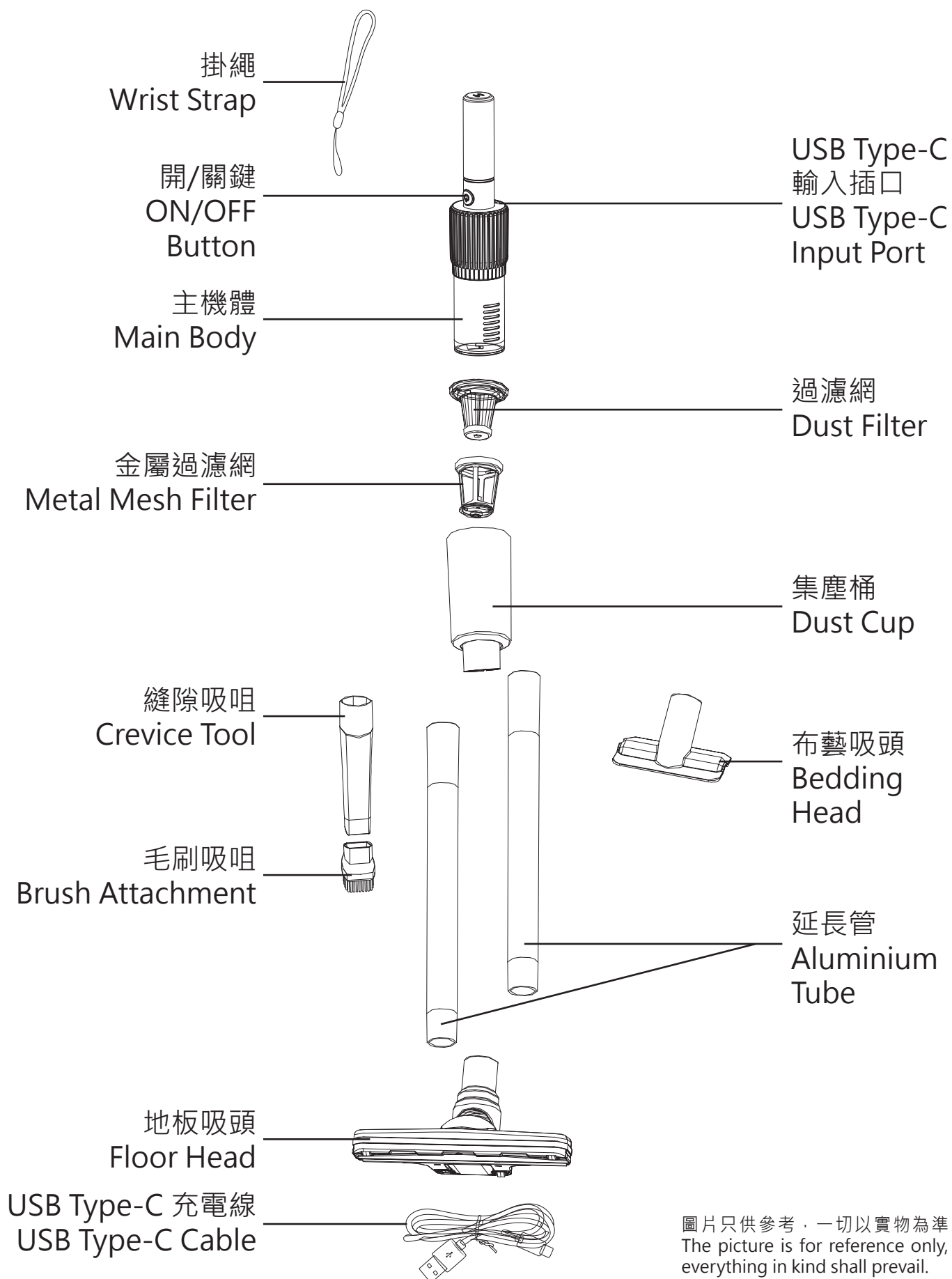

圖片只供參考·一切以實物為準
The picture is for reference only,
everything in kind shall prevail.

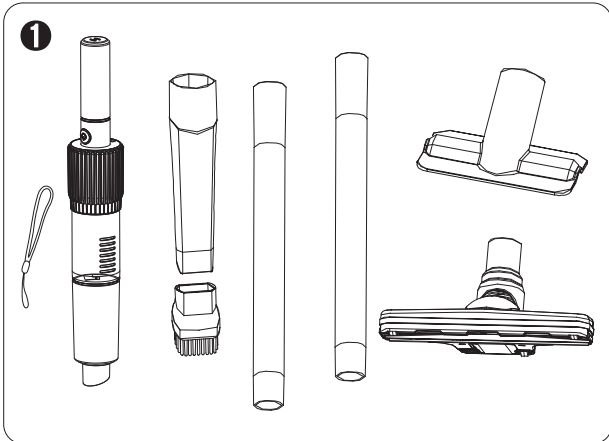

1. 打開包裝，取出主機及配件。
Take out the relative accessories.

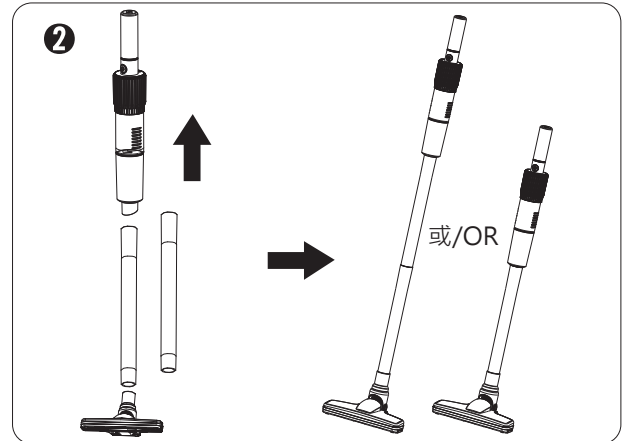

2. 將延長管插入主機體，將地板吸頭與延長管接連。(可以選擇安裝一條或兩條延長管)

或

Insert the extension tube into the main machine, connect the floor head with the extension tube. (Option to install one or two extension tube)

OR

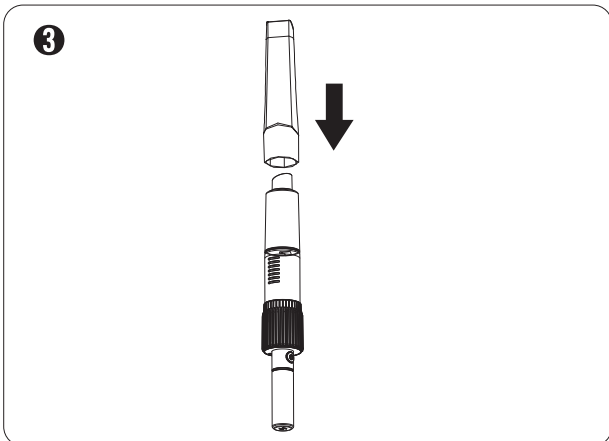

3. 將縫隙吸咀插入吸氣口上。縫隙吸咀適用於清理汽車門縫、座椅等各種縫隙處的灰塵。

或

Insert the crevice tool into the suction inlet. Crevice nozzle is suitable for cleaning dust in various crevices such as car door gaps, seats.

OR

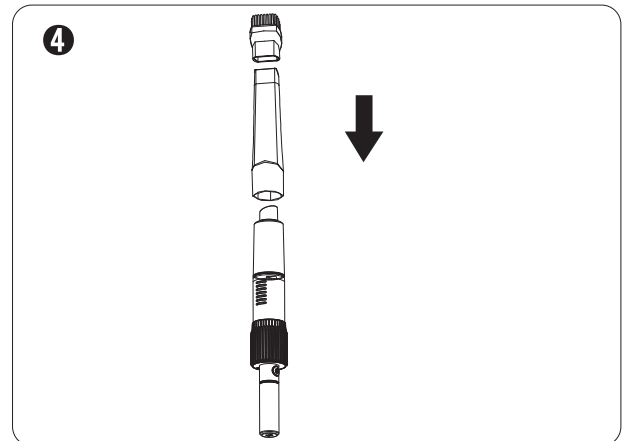

4. 將毛刷吸咀插入縫隙吸咀上。毛刷吸咀適用於清理座椅墊、腳墊、鍵盤以及帶有天鵝絨表面的空調出風口等各種表面的灰塵。

或

Insert the brush attachment into the crevice tool. Brush attachment is applicable for cleaning surfaces like seat cushions, floor mats, keyboards, and air conditioning vents with velvet textures.

OR

5



5. 將布藝吸頭插入吸氣口上。布藝吸頭適用於清潔大面積、開闊平坦的區域(例如:沙發或床單)。

Insert the bedding head into the suction inlet. It is suitable for cleaning large, open and flat areas (Such as sofas or bed sheets).

6

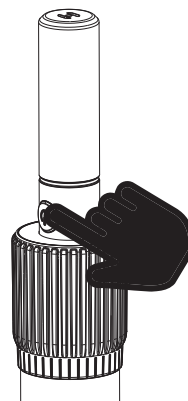

6. 按開/關鍵，電源顯示燈亮起，吸塵機以速度1開始工作。再按開/關鍵轉為速度2，再按開/關鍵關閉吸塵機。

Press the ON/OFF button, power Indicator light on, then start working as speed 1. Press this button again to switch to speed 2, press this button again to turn off the Vacuum Cleaner.

7

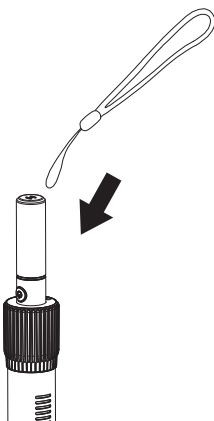

7. 掛繩可安裝在主機體上。

The wrist strap can be installed on the main unit.

圖片只供參考，一切以實物為準
The picture is for reference only,
everything in kind shall prevail.

充電/操作時間 | CHARGING/OPERATION TIME:

- 充電時間：約5小時。
- Charging Time : Approx. x Hours.
- 操作時間：最長約30分鐘(根據不同設定)。
- Operation Time : Approx. 30 Mins (Max.) (Depending on different settings).
- 提示：根據電池壽命，充電電池的使用時間會持續縮短。
- Reminder : According to the battery nature, the using time of the rechargeable battery will be shortened continuously.

充電 | CHARGING :

將USB線連接到設備(例如:電源適配器(需自備))，另一端連接到產品的電源輸入端口，為本產品充電。

Connect the USB cable to a device(e.g. power adaptor(not included)), and the power input port of the product to charge the product.

- 首次充電時間: 最少充電約5小時。
- First charging time: At least x Hours.
- 充電時充電指示燈顯示紅色，充電完成時，指示燈轉為綠色。
- The charging indicator light turn red while charging and the indicator light turns green when charging is complete.
- 如本產品長期不使用時，建議每三個月充電一次，避免電池損壞導致產品不能使用。
- It is recommended to charge it every 3 months to avoid battery damage and affect product functions if the product is not working for a longtime.
- 建議使用DC5V 2A電源充電，否則會使充電電池的壽命縮短。(電源適配器不包括在內)
- It is recommended to use DC5V 2A power supply for charging to achieve the better battery performance. (Power adaptor not included)
- 充電及使用時間視乎設定和環境因素而定；實際結果可能有所差異。
- Charging and operation time vary with settings and environmental factors; actual results will vary.

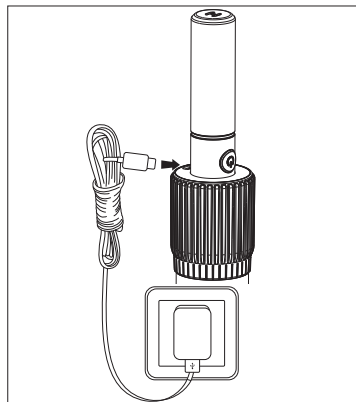

圖片只供參考，一切以實物為準
The picture is for reference only,
everything in kind shall prevail.