

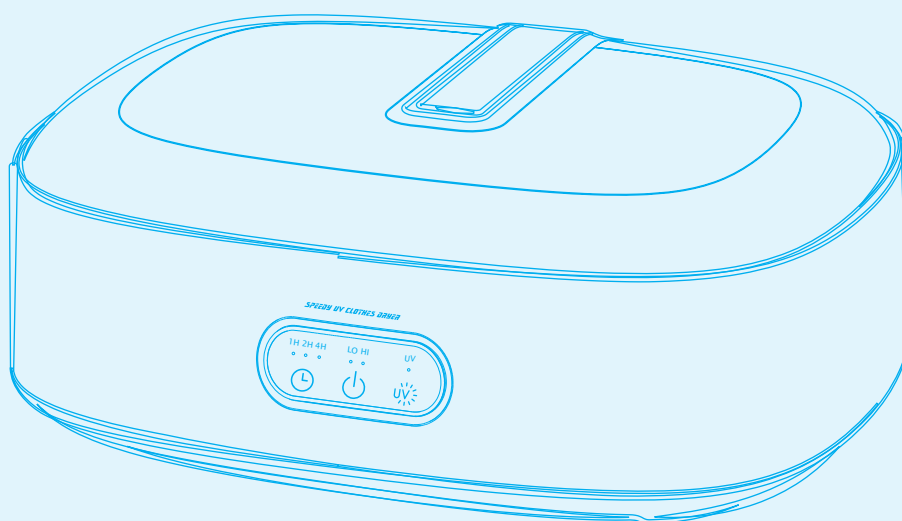

快速 UV 殺菌乾衣寶 Speedy UV Clothes Dryer





CD600

使用說明書

INSTRUCTION MANUAL

- * 使用本產品前，請先細閱使用說明書，並請妥善保存以便將來翻閱。
- ** 本說明書可於本公司網站下載 www.origo.hk。
- * Read all instructions carefully before using the appliance, and keep this instruction for future reference when necessary.
- ** This instruction manual can be acquired at www.origo.hk.

- 使用乾衣寶前，請先細閱使用說明。
Read all instructions carefully before using the Clothes Dryer.
- 本機不是為8歲以下小孩，體質、感覺或智力有障礙人士或缺乏經驗及知識者使用，除非他們曾經接受負責安全人士的監督或指示。大人應指導小孩不可把玩電器。
This appliance can be used by children aged from 8 years and above and persons with reduced physical, sensory or mental capabilities or lack of experience and knowledge if they have been given supervision or instruction concerning use of the appliance in a safe way and understand the hazards involved. Children shall not play with the appliance. Cleaning and user maintenance shall not be made by children without supervision.
- 未滿3歲的小孩除非受到持續監護，否則應該遠離本產品。
Children of less than 3 years should be kept away unless continuously supervised.
- 年齡在3至8歲的小孩只有在產品已經被放置或安裝在其預期的正常操作位置，並已經接受了使用本產品的安全指導或監督並理解可能存在的危險時，才能開關產品。其不得插拔電源、調節和清潔產品，也不得進行用戶維護。
Children aged from 3 years and less than 8 years shall only switch on/off the appliance provided that it has been placed or installed in its intended normal operating position and they have been given supervision or instruction concerning use of the appliance in a safe way and understand the hazards involved. Children aged from 3 years and less than 8 years shall not plug in, regulate and clean the appliance or perform user maintenance.
- 使用時確保乾衣寶懸掛在不易掉落的配件上，且主體部分嚴禁進水。
Use this Clothes Dryer hung on the attachment which is not easy to fall, and the main part is prohibited water in.
- 如本產品的電源線有損壞痕跡，為保障安全，請立即停止使用並聯絡供應商更換。
If the supply cord is damaged, it must be replaced by manufacturer, its service agent or similarly qualified persons in order to avoid a hazard.
- 如乾衣寶有明顯的損壞跡象，請勿使用。
Do not use if there are visible signs of damage to the Clothes Dryer.
- 警告：除非提供持續監督，否則當無法自行離開房間的人佔用時，請勿在細小房間內使用此乾衣寶。
WARNING: Do not use this Clothes Dryer in small rooms when they are occupied by persons not capable of leaving the room on their own, unless constant supervision is provided.
- 請不要使用曾經掉落的乾衣寶。
Do not use this Clothes Dryer if it has been dropped.
- 切勿把乾衣寶擺放於電源插座之下。
The Clothes Dryer must not be located immediately below a socket outlet.
-  警告：為防乾衣寶過熱，切勿覆蓋乾衣寶的出、入風口。使用中的乾衣寶出口會發出高熱，切勿觸碰。
-  WARNING: In order to avoid over heating, do not cover the Clothes Dryer. The Clothes Dryer is hot when in use. To avoid burns, do not let bare skin touch hot surface.

- 警告：乾衣寶的入風口應與易燃物品(如傢俱、枕頭、床舖、毛巾或窗簾等)保持安全距離不少於1米。

WARNING: To reduce the risk of fire, keep textiles, curtains, or any other flammable material a minimum distance of 1 m from the air inlet of the Clothes Dryer.

- 乾衣寶不可擺放於有潛在危險的地方使用(例如：非常潮濕環境、易燃物品或化學品倉庫)。

The Clothes Dryer must NOT be used in potentially dangerous location such as flammable explosive, chemical laden or wet atmospheres.

- 乾衣寶不適用於室外及作工業用途。
Clothes Dryer is intended for household use ONLY, not for industrial or outdoor use.

- 打開包裝，檢查產品。如發現產品有損壞，請勿使用及即時聯絡供應商。請使用獨立插座。

Remove the package and ensure that the Dryer is undamaged. In case of doubt do not use the Dryer and contact your supplier.

- 包裝物料並非玩具，不可讓小孩玩耍。
Do not let children play parts of package.

- 使用萬能插頭或拖板，容易發生危險。
Avoid using extension cord as the extension cord may overheat and cause fire.

- 掛衣服前，產品電源插頭必須保持乾燥；當產品準備連接電源時，操作前請保持雙手乾燥，以免觸電。

Before hanging clothes, the power plug of the product must be kept dry; when the product is ready to be connected to the power supply keep hands dry before operation to avoid electric shock.

- 使用乾衣寶前，請確定規格標貼上所示的額定電壓與當地供電電壓相同。如有疑問可向供應商查詢。

Before using the Clothes Dryer, check if the voltage marked on the rating label corresponds to the mains in your home.

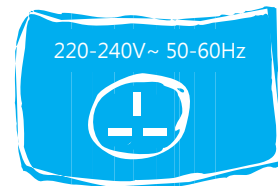

- 拔除插頭時不可拉扯電源線，必須緊握插頭，把插頭拔出。

Do not pull the power cord to disconnect with power source. Always grasp the plug to pull out.

- 警告：開/關鍵不應作為切斷電源用途。

WARNING: The On/Off key should not be used as the sole means of disconnecting power.

- 警告：清潔前必須先拔除電源插頭。
WARNING: To avoid danger of electric shock, unplug from outlet when not in use and before cleaning.

- 乾衣寶不可擺近水盆、浴缸、花灑、泳池、潮濕或有積水的周邊環境使用。

The Clothes Dryer is not intended for use in the immediate surroundings of a basin, a bath, a shower, a swimming pool, a wet or damp locations.

- 警告：本產品僅適用於烘乾衣物和洗滌紡織品。

WARNING: This product is only suitable for drying clothes and washing textiles.

- 切勿將任何異物放入乾衣寶內；或阻擋機身熱風出口及入風口；或將乾衣寶放置在柔軟或不穩固的表面上(例如床鋪)，皆因以上一切行為均會導致機身過熱，引發短路或火警。
Do not insert any objects into the Clothes Dryer as it may cause an electric shock or fire or damage to the Clothes Dryer. Do not block or tamper with the Clothes Dryer in any manner while it is in operation. To prevent a possible fire, do not block air inlet or hot air outlet in any manner. Do not place on soft surfaces, like a bed, where opening may become blocked.
- 使用本產品前，需檢查主機熱風出口、上、側進風口是否被織物、絮狀物、灰塵等堵塞，若主機進風口堵塞，必須及時用刷子等工具清除；若出風口堵塞，請確保清除阻塞物後才可使用。
Before using this product, it is necessary to check whether the hot air outlet, the upper and side air inlet of the main engine are blocked by textile, flocculate, dust, etc. If the air inlet of the main engine is blocked, it must be removed with brush and other tools in time; if the air outlet is blocked, please make sure to remove the blockage before using.
- 本產品專為衣物快速乾燥和護理功能而設計，不能用作暖風機、吹風機、淨化器等產品，以免乾衣寶發生故障。
This product is designed for fast drying and care functions of clothes, cannot use as heater, blower, purifier and other products, to avoid Clothes Dryer failure.
- 使用乾衣寶時，乾衣寶與牆壁最少保持30毫米距離。
Keep a distance of at least 30 mm between Clothes Dryer and the wall.
- 乾衣前，應注意衣物上的標籤，認清該衣物是否可使用乾衣寶及使用溫度限制。
Check the clothing care label before drying, make sure they can be dried using the Clothes Dryer, pay special attention to its temperature limits.
- 如果衣服是襯衫或T恤等，請確保衣領不會遮擋上部進風口，並且不要在衣櫃或衣服或高密度環境中使用該產品，以免影響工作影響產品或導致產品過熱保護和停機。
If the clothes are shirts or T-shirts, etc, make sure that the collar does not block the upper air inlet, and do not use the product in the wardrobe or clothes or in environment of high density, so as not to affect the working effect of the product or cause overheating protection and shutdown of the product.
- 乾衣寶只適用於外套、襯衫、T恤、短褲、背心、嬰兒背心、女士內衣衣服、內衣、襪子等（禁止附著大型家用紡織品）。
The Clothes Dryer is only suitable for coat, shirt, T-shirt, shorts, vest, infant singlet, women's underwear clothes, underwear, socks, etc. (It is forbidden to attach large home textile products).
-  本產品含有可回收材料，不可把本產品作為未分類廢物。請聯繫當地就近指定回收點。
 This product contains recyclable materials. Do not dispose this product as unsorted municipal waste. Please contact your local municipality for the nearest collection point.

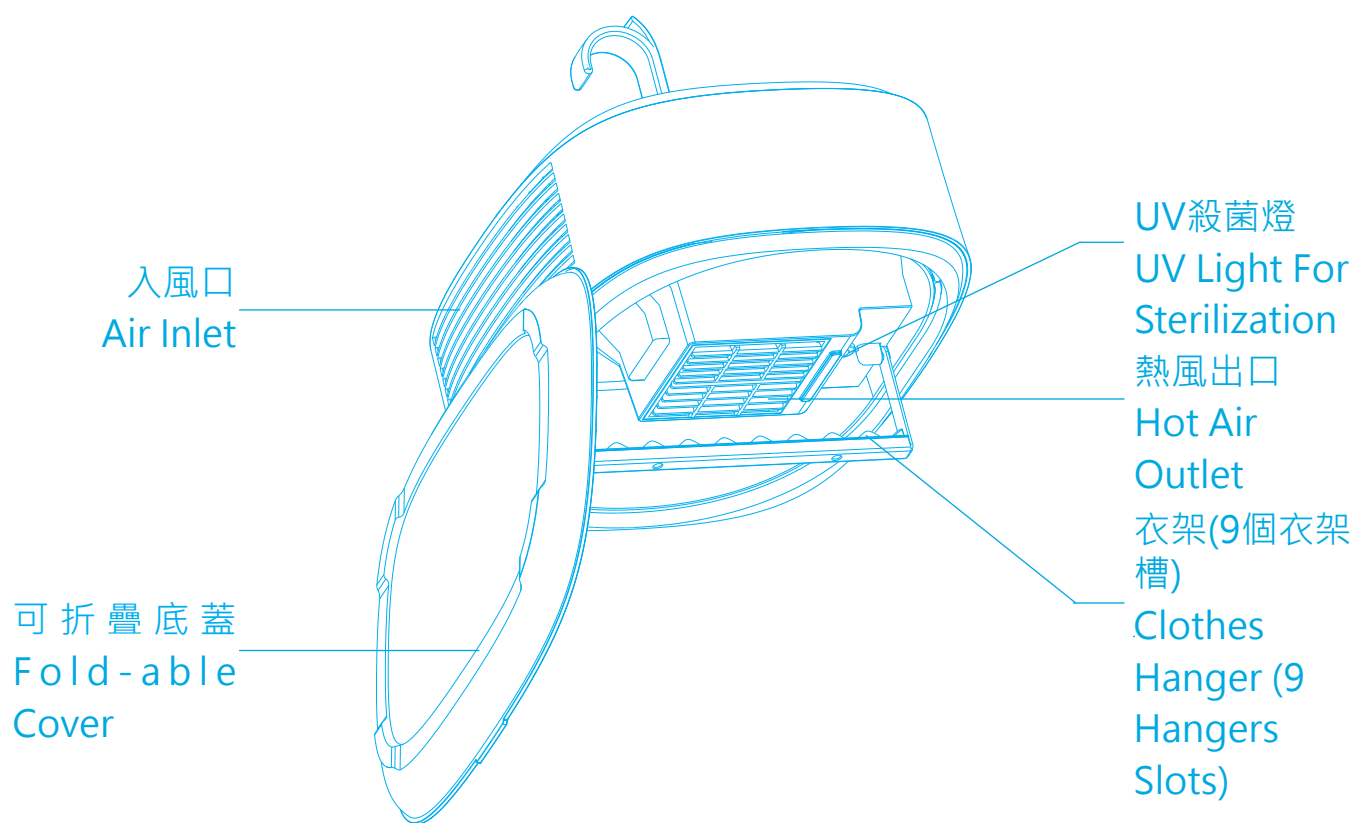
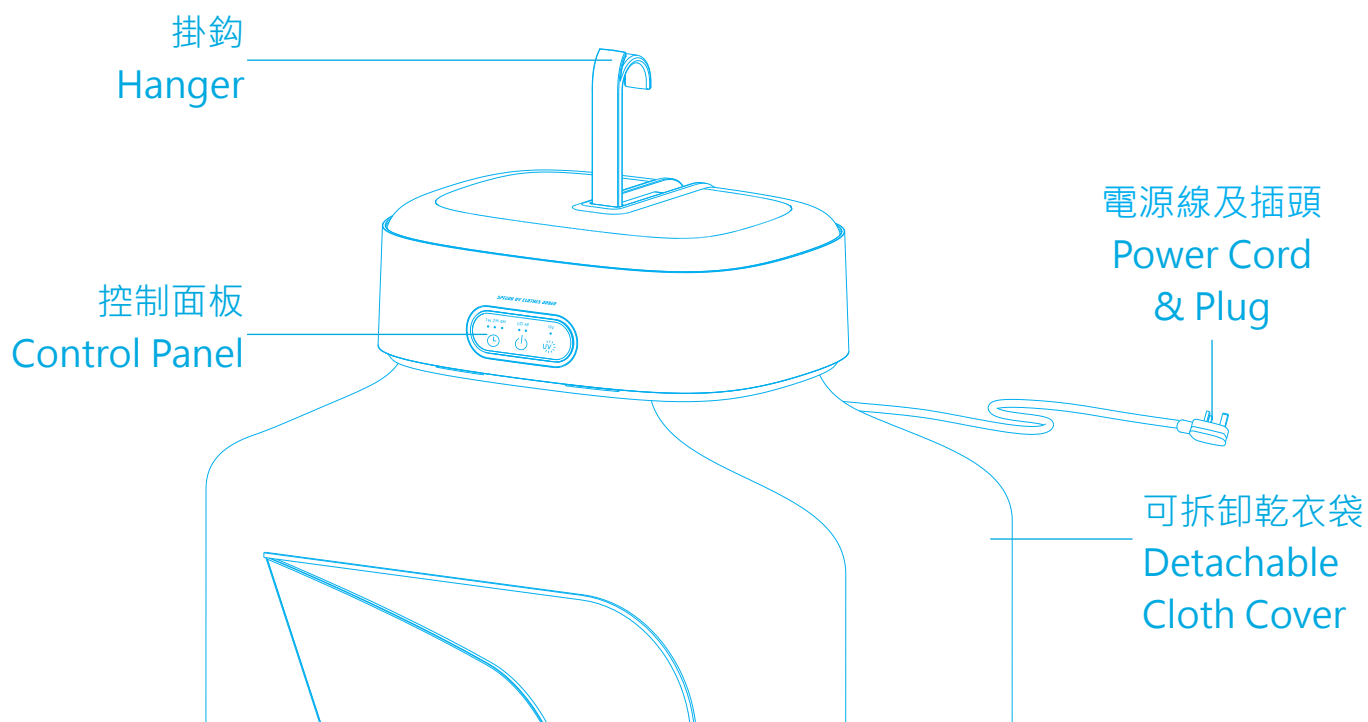

圖片只供參考，一切以實物為準
The picture is for reference only,
everything in kind shall prevail.

1

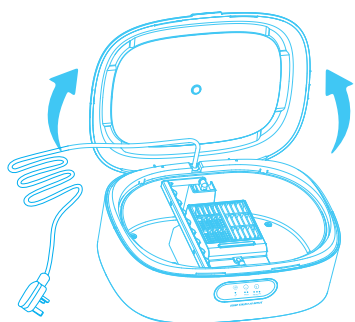

1. 打開乾衣寶底蓋，取出內部電源線。
Open the Clothes Dryer fold-able cover and take out the internal power cord.

2

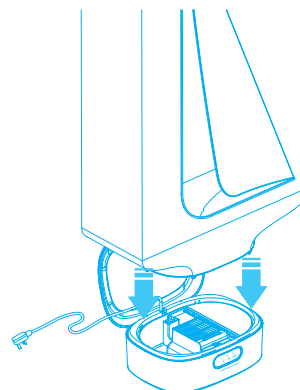

2. 組裝乾衣袋：將乾衣寶倒置及將乾衣袋四個卡扣插入乾衣寶邊緣孔內。
Assemble the cloth cover: Turn the Clothes Dryer upside down and insert the four buckles of the cloth cover into the edge holes of the Clothes Dryer.

3

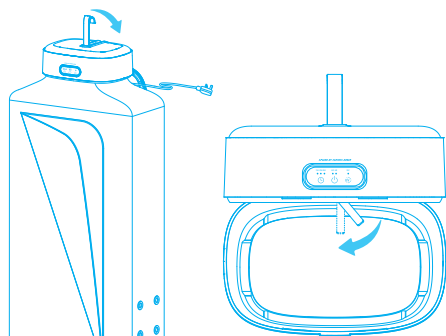

3. 打開掛鉤，整理乾衣袋。將掛鉤置於垂直位置。
Open the hanger and arrange the cloth cover. Put the hanger in a vertical position.

4

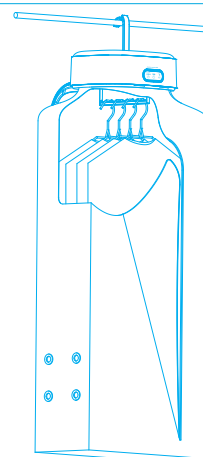

4. 將衣服掛在衣架上，拉上拉鍊，掛上掛鉤並接上電源，乾衣寶即可進入工作狀態。
Put the clothes on the clothes hanger, pull the zipper, hang the hook and connect it to the power supply, then the Clothes Dryer can enter the working state.

圖片只供參考，一切以實物為準
The picture is for reference only,
everything in kind shall prevail.

懸掛使用注意事項

Precautions For Hanging Use

請勿靠牆懸掛，容易堵塞進風口，影響烘乾效果並造成乾衣寶損壞。

Do not hang it against the wall, it is easy to block the air inlet, affect the drying effect and cause damage to the Clothes Dryer.

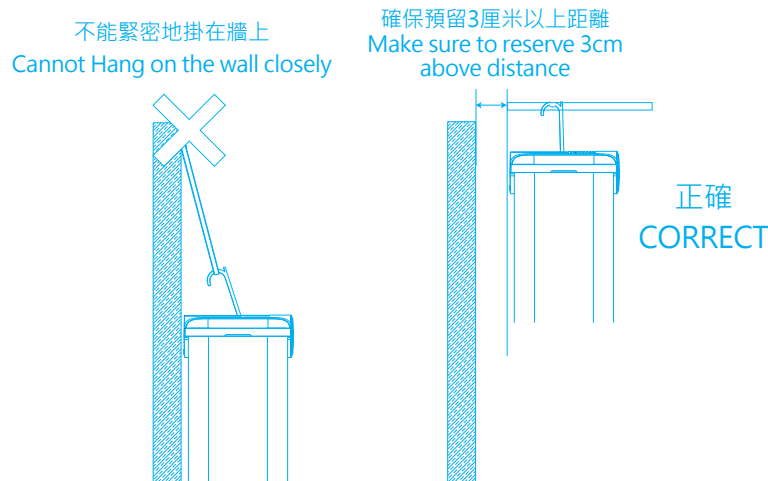

單件和多件衣物的懸掛技巧

Hanging Skills Of Single And Multiple Clothes

建議以以下懸掛方式晾乾，效果較佳：

Recommend to use the following hanging methods to dry, effect is better:

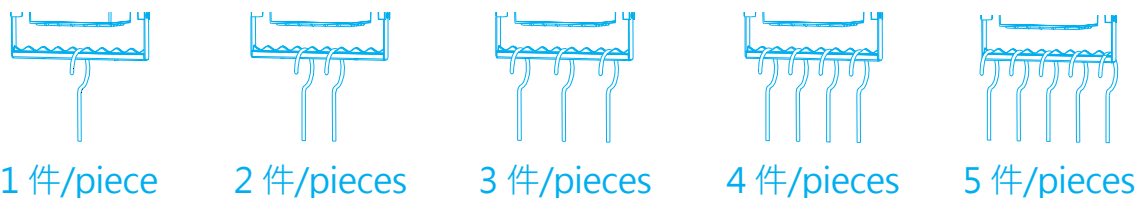

- 每次最多只能掛上5件衣物及最多8公斤衣物。

A maximum of 5 pieces of clothing and a maximum of 8 KG of clothing can be hung at a time.

- 長袖衣服，袖子盡量抖鬆整理得直。

Long sleeve clothes, sleeves as far as possible shake loose finishing straight.

- 長褲、長裙等衣服，建議對摺後才掛在衣架上。

Trousers, dresses and other long clothes, it is recommended to fold in half then hang on it.

- 只可使用塑膠衣架，不建議使用鐵或不銹鋼或木製衣架，以免負荷過重。

Only plastic hangers can be used, it is not recommended to use iron or stainless steel or wooden hangers to avoid overloading.

圖片只供參考，一切以實物為準
The picture is for reference only,
everything in kind shall prevail.

乾衣寶可使用機身控制面板操控。

The Clothes Dryer may be operated by the control panel.

將插頭插入交流電220-240伏特，50-60赫茲的獨立插座，乾衣寶會"嗶"聲響起，乾衣寶進入待機模式。

Plug the power plug into an 220-240V~, 50-60Hz electrical outlet, the Clothes Dryer will have a "beep" sound, the Clothes Dryer is enter to the standby mode.

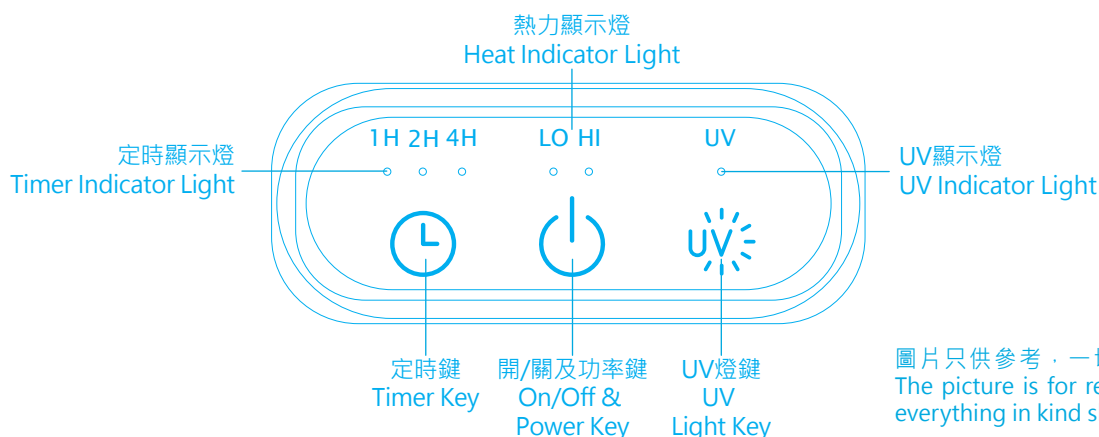

1. 在待機狀態下，按開/關及功率鍵 "⏻"，乾衣寶將開啟低熱模式，連續按此鍵可循環切換工作模式：低熱模式或高熱模式或待機狀態。

In standby mode, press the on/off & power key "⏻", the Clothes Dryer will turn on the Low Heat mode, continuously press this key to cycle through the working modes: Low Heat mode or High Heat mode or standby mode.

2. 在工作狀態下，使用 "🕒" 鍵連續按下選定7個不同的自動關機時間，分別由1至7小時，並有指示燈顯示已選擇的時間。

In the working state, Press "🕒" key continually to set desired auto power off time. There are 7 time intervals, from 1-hour to 7-hour, for auto power off. The LED light indicates the time selected.

3. 在待機狀態或工作狀態下，可按UV燈鍵 "☀️" 開啟UV燈。
當UV燈開啟時，再次按此鍵可關閉UV燈。

In standby mode or working state, press the UV light key "☀️" to open the UV light.

When the UV light is on, press this key again to turn off the UV light.

4. 關機：如需關機，按 "⏻" 鍵。

OFF: To turn the Clothes Dryer off, press the "⏻" key.

注意/Notice:

為加強使用安全，本乾衣寶預設8小時強制關機功能。

In order to enhance the safety of use, this Clothes Dryer is preset with a 8-hour forced shutdown function.

注意 / CAUTION:

警告: 不使用乾衣寶時，經常保持拔除電源，及切勿將乾衣寶浸於水或其他液體中。在清潔本乾衣寶前，先將乾衣寶關掉及把電源線從插座拔出。

WARNING: ALWAYS UNPLUG THE POWER CORD BEFORE MOVING OR SERVICING. DO NOT IMMERSE THE CLOTHES DRYER IN WATER! BEFORE CLEANING, MAKE SURE THAT THE UNIT HAS BEEN SWITCHED OFF AND IT IS UNPLUGGED FROM THE MAIN OUTLET.

外殼: 清理時切勿將乾衣寶浸於水或其他液體中。使用濕潤軟布抹擦清潔，頑固污垢可用軟布沾上含肥皂的溫水抹擦。

Housing: Clean the outside and grille of the Clothes Dryer with a soft cloth. To remove persistent dirt, wipe down with a cloth that has been dampened with warm soapy water.

切勿使用研磨性、腐蝕性或易燃性清潔劑(例如漂白劑或酒精)清潔乾衣寶的任何部位。
Do NOT use abrasive, corrosive or flammable cleansers (such as bleach or alcohol) to clean any part of the Clothes Dryer.

乾衣袋的拆卸和清洗方法 / The Removal And Washing Method Of Cloth Cover

- 握住乾衣寶外殼以取下乾衣袋。

Hold the housing of Clothes Dryer to remove the cloth cover.

- 為防止乾衣袋變形，請勿使用洗衣機洗清洗乾衣袋，建議使用手洗。

To prevent the deformation of the cloth cover, do not use washing machine wash to wash the cloth cover, it is recommended to use hand wash.

存放方法 / Storage Method:

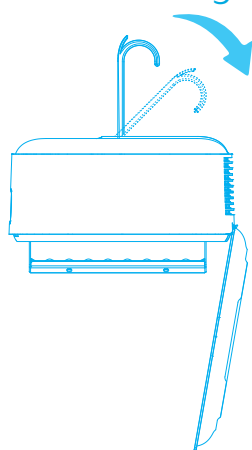

1. 關閉乾衣寶並拔除電源線。收起掛鉤。
Switch off the Clothes Dryer and unplug the power cord. Close the hanger.

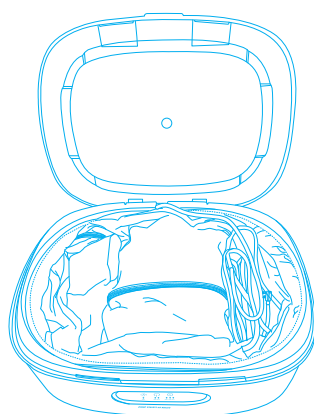

2. 放下衣架，整理好乾衣袋和電源線，完全放入收納空間。
Lay down the clothes hanger, arrange the cloth cover and power cord, and put them into storage space completely.

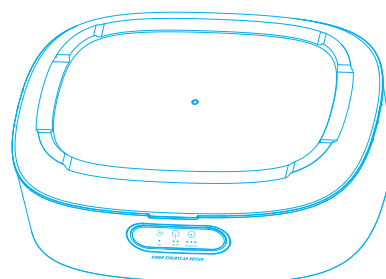

3. 合上底蓋，方便攜帶收納。
Close the cover for easy carrying and storage.

儲存: 連同使用說明，把乾衣寶存放於清涼及乾爽的地方。

STORAGE: Store the Clothes Dryer with these instructions in the original box in a cool and dry place.

技術規格 Specification

快速 UV 殺菌 乾衣 寶
Speedy UV Clothes Dryer



型號 Model Number	CD600
電源 Power Supply	220-240V~ 50-60Hz
額定功率 Rated Power	600W
最大負載量 Max. Loading	8公升/ KG(約/Approx.)
產品尺寸 Product Dimension	290(W) x 115(H) x 220(D) mm(摺疊後/Folded) (約/Approx.)

源澤地圖 Origin Map

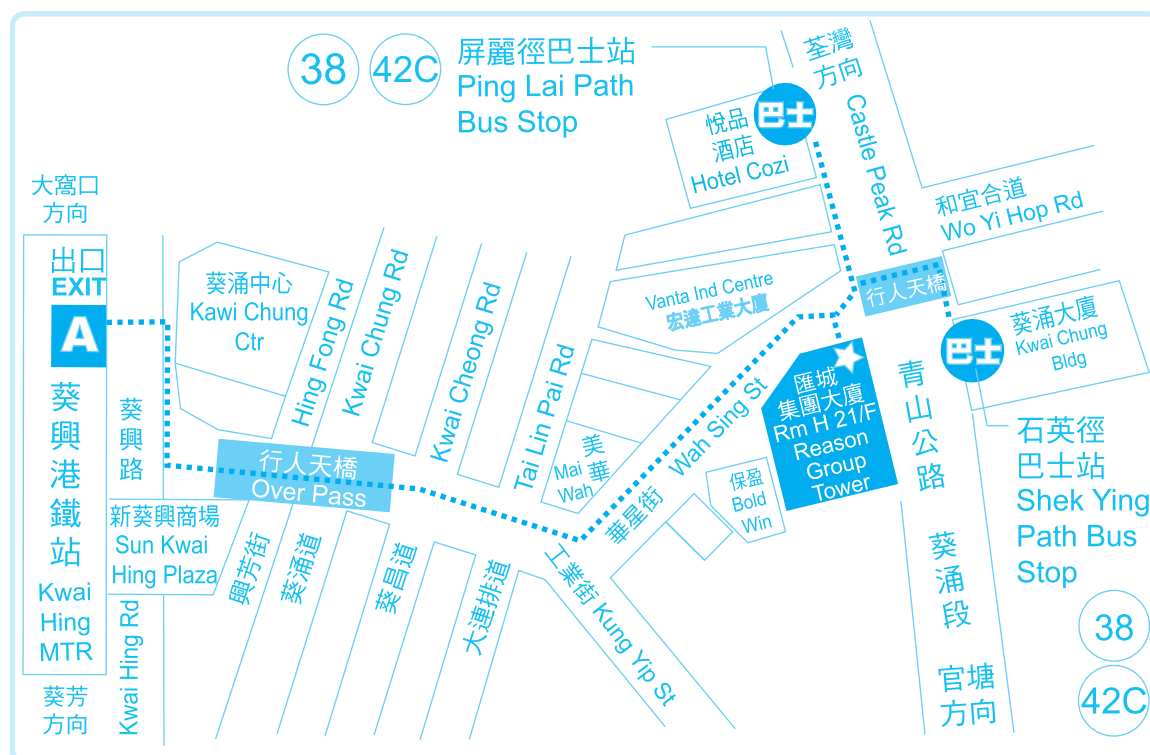

辦公時間

10:30am - 12:30pm (星期一至五)
02:30pm - 05:30pm (星期一至五)
10:30am - 12:30pm (星期六)
(星期日及公眾假期休息)

OFFICE HOURS

10:30am - 12:30pm (Mon to Fri)
02:30pm - 05:30pm (Mon to Fri)
10:30am - 12:30pm (Saturday)
(Closed on Sunday and Holiday)

保用

快速 UV 殺菌乾衣寶
Speedy UV Clothes Dryer



產品： 快速UV殺菌乾衣寶

型號： CD600

此產品由購買日期起計算，本公司將根據下列條款及細則，提供一年保養服務(商業用途則為3個月):

1. 於購買後一年內，經本公司技術員判斷為正常運作下損壞之產品，可獲免費維修和/或零件更換。

2. 以下情況不被包括在保養範圍內：

- 若產品是因為濫用、錯誤使用、疏忽及/或意外而遭致損壞；
- 未經本公司授權之自行處理、維修及/或改裝；
- 任何機殼、面蓋、可拆卸乾衣袋、掛鉤、電源線及插頭，以及配件。

3. 需要檢查或維修時，請將產品送往本公司服務中心，並於修理妥當後自行取回。

4. 更換後之任何零件或配件，均屬本公司所有。

5. 本保養服務只適用於香港特別行政區。

6. 顧客必須同時出示零售商之正式發票，方可得到免費維修服務。

升級保用：(須於購買本產品後10天內完成以下步驟；升級保用不適用於商業用途)

A. 額外3個月保用: 於本公司網站完成登記，可享有共15個月免費保用；或

B. 額外6個月保用: 到訪並“追蹤”本公司 (Origin Marketing Limited) 的Facebook，即可享有共18個月免費保用。(如果已追蹤，則自動享有此升級保用，毋須再進行上述步驟)。

www.origo.hk



Find us on



服務中心

源澤市務有限公司

香港新界葵涌青山公路403號(近華星街12號)匯城集團大廈21樓H室

電話: 2156 8238 www.origo.hk

Warranty

Item : Speedy UV Clothes Dryer

Model : CD600

This product is warranted for 1 year (commercial use for 3 months) from the date of purchase under the following conditions:

1. For any defect, in the judgment of our technician, if it is caused under normal use, we are responsible for repairing the product, and/or replacing parts at free of charge.

2. This warranty DOES NOT apply to:

- If the product was damaged by abuse, misuse, negligence or accidents;
- Repair, alteration/modification by unauthorized technician;
- The housing, cover, detachable cloth cover, hanger, power cord & plug or accessories.

3. The customer is requested to bring the product to and from our Service Centre.

4. Any parts or accessories, which had been replaced, shall be of our property.

5. This warranty is valid in H.K.S.A.R. only.

6. Original invoice should be presented in order to get free service.

Extended Warranty: (Complete following procedure within 10 days from the date of purchase.

Extended warranty does not apply to commercial use)

A. Extra 3 months warranty: complete Online Warranty Registration on our website to enjoy a total of 15 months of warranty; or

B. Extra 6 months warranty: follow "Origin Marketing Limited" on Facebook to enjoy a total of 18 months of warranty. (If you have already followed, no need to do it again.)

Service Centre

ORIGIN MARKETING LIMITED

Unit H, 21/F., Reason Group Tower (nearby 12 Wah Sing Street),

403 Castle Peak Road, Kwai Chung, N.T., Hong Kong.

Tel: 2156 8238 www.origo.hk

www.origo.hk



Find us on

