

origo 迷你加濕器

為了使您能更瞭解本產品的性能和使用時的安全，請使用前務必詳細閱讀以下說明。

一、型號及規格

型號：MH-208
電壓：100-240伏特~，50/60赫茲
功率：13瓦特(±20%)



二、注意事項

- 1) 使用本產品前，請詳細閱讀本說明書。
- 2) 產品只供室內使用。
- 3) 產品不是玩具，應避免孩童單獨使用本產品。
- 4) 產品並不適合用於商業用途。
- 5) 不要移動帶有水的加濕器。
- 6) 不要直接加水入水槽內。
- 7) 切勿將超過攝氏40度的熱水裝入水瓶。
- 8) 若加濕器要清洗，加水或移動時，必須先關閉電源並拔除電源插頭。
- 9) 清潔時切勿讓水流入或濺入機體內部。
- 10) 當發現有異常的噪音或氣味時，應立即停止使用本機。
- 11) 必須將設備放在牢固的平面上。
- 12) 不要讓噴霧嘴直接面對牆壁和電器。
- 13) 請勿用濕手拔除插頭，以免發生觸電危險。
- 14) 使用本機時不要用手觸摸水槽內的水。
- 15) 切勿將金屬品、化學藥品、洗滌劑放入水槽，否則會出現霧化不良的現象。
- 16) 切勿在水槽內缺水的時候開啟加濕器。
- 17) 倒出水槽內的水時，請先關閉電源，拔除插頭。
- 18) 不可擅自拆卸、修理、改造本產品。

- 19) 本機不是為體質、感覺或智力有障礙人士(包括小孩)或缺乏經驗及知識者使用，除非他們曾經接受負責安全人士的監督或指示。大人應指導小孩不可把玩電器。

三、使用方法

- 1) 將加濕器放在水平的平面上。將噴霧嘴放在設備上。請將本機遠離牆壁和熱源，如發熱的爐具，散熱器等。

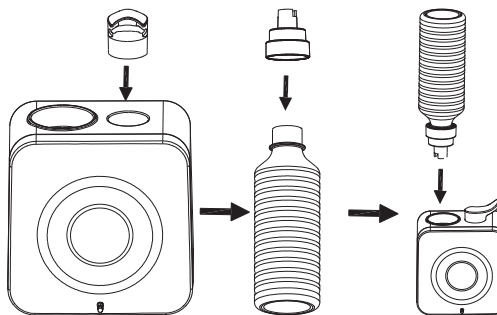

- 2) 用水瓶連接器將水瓶鎖緊。
- 3) 將裝上水瓶連接器的水瓶瓶口向下並插入水槽內。將變壓器接駁到電源輸入端口，再將插頭插入適當的插座上。
- 4) 順時針旋轉控制旋鈕，加濕器啟動，指示燈將會變為綠色，並開始釋放霧氣，旋轉控制旋鈕可調節霧量大小。
- 5) 當水槽內缺水的時候，指示燈將會變為紅色，本機將會自動關機。

四、清潔保養

- 1) 清潔前，您必須關閉電源，然後拔下插頭。
- 2) 請將水打則倒出，否則水將倒入機內，將會發生損壞。
- 3) 可使用軟布或原裝配備的刷子清潔及用清水沖洗。

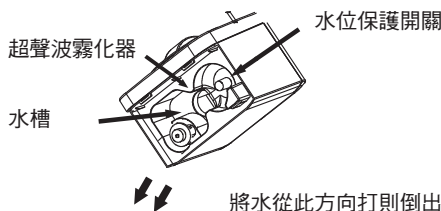
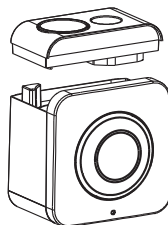

五、保用

本機可獲自領取日起1年免費保用(商業用途享有三個月免費保用)。此保用只包含生產所導致的品質問題；並不包括及噴霧嘴、水瓶連接器及其他附件，因誤用或不依說明書指示使用而導致的損壞。

***額外3個月保用：凡於購買產品後10天內完成網上登記，即可免費延長保用期3個月，即15個月免費保用(商業用途除外)。請即登入網站：www.origo.hk

注意：保用時，須帶同收據及請先致電服務中心。

服務中心

源澤市務有限公司
香港新界葵涌青山公路403號
匯城集團大廈21樓H室(近華星街12號)
電話：2156 8238

辦公時間

上午10:30 - 下午12:30 (星期一至五)
下午02:30 - 下午05:30 (星期一至五)
上午10:30 - 下午12:30 (星期六)
(星期日及公眾假期休息)

源澤地圖

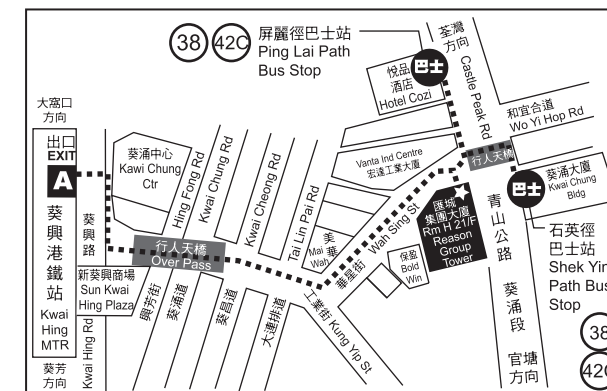

origo Mini Humidifier

Thank you for your purchase of our mini humidifier. To use this humidifier properly and safely, please read the following instruction carefully.

1. MODEL & SPECIFICATION

Model : MH-208
Voltage : 100-240V~50/60Hz
Power : 13W(±20%)

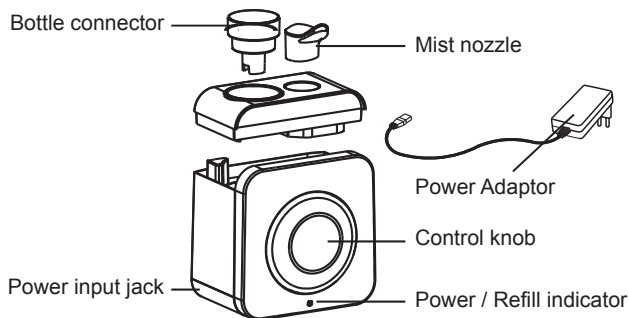

2. ATTENTIONS

- 1) Read all instructions and warnings carefully before use.
- 2) This product is for indoor use only.
- 3) This product is not a toy. Do not allow children to play it.
- 4) This product is designed for household use only.
- 5) Don't move the humidifier with water.
- 6) Don't fill water into the flume directly.
- 7) Don't fill any water which over 40°C into the water bottle.
- 8) Do not wash, adjust or move the unit without first unplugging unit from its electrical outlet.
- 9) Never let water flow or splash into the inside of the unit when washing.
- 10) Stop using the unit when there is unusual noise or smell.
- 11) Always place the unit on a firm, and flat surface.
- 12) Do not allow the mist nozzle to directly face the wall and home appliances.
- 13) Do not plug in the unit with wet hands.
- 14) Do not touch the water in the flume.
- 15) Never add any additive to the water.
- 16) Don't turn on the humidifier when there is no water in the water basin.
- 17) Do not allow to spill out the remaining water before unplugging the unit.
- 18) Do not attempt to repair or adjust the unit.

- 19) Reminder: This appliance is not intended for use by persons (including children) with reduced physical, sensory or mental capabilities, or lack of experience and knowledge, unless they have been given supervision or instruction concerning use of the appliance by a person responsible for their safety. Children should be supervised to ensure that they do not play with the appliance.

3. DIRECTIONS FOR USE

- 1) Place the humidifier on a hard, flat and horizontal surface. Put the mist nozzle onto the device. Always keep it away from walls and heat sources such as stoves, radiator, etc.

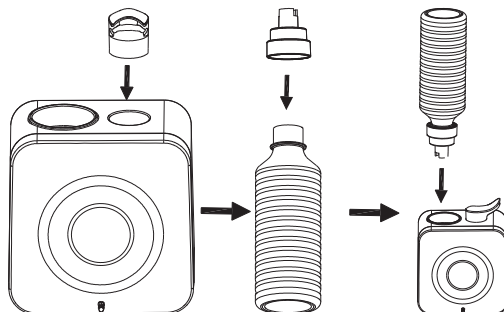

- 2) Lock the bottle connector with the water bottle.
- 3) Turn water bottle upside down and insert to the flume of unit. Plug the power jack of power adaptor to the power input jack socket, then connect the power adaptor to the main socket.
- 4) And then turn the control knob clockwise, unit power on and green indicator will light up and release the mist, turning the control knob can adjust the volume of mist.
- 5) The red indicator light will turn on when the water in the flume is empty, and the unit will power off automatically.

4. MAINTENANCE & CARE

- 1) Before cleaning, you must turn the power off and unplug the unit.
- 2) Please pour out the water obliquely, otherwise the water will pour into the unit and damage will occur.
- 3) Clean them by using a brush and a soft cloth, and wash with clean water.

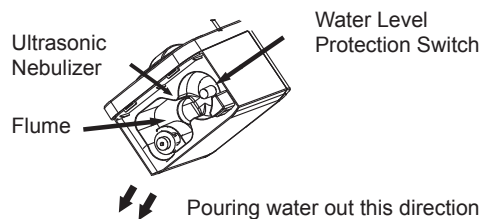
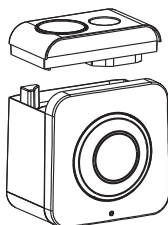

5. WARRANTY

This product is guaranteed for 1 year (commercial use for 3 months) from the date of receipt against manufacturing defect. The warranty does not cover the mist nozzle, bottle connector and other accessories, damage or defect caused by negligence or use not according to this instruction manual.

***Extra 3 months warranty: just complete Online Warranty Registration within 10 days from the date of receipt, free warranty will be extended to 15 months (not applicable to commercial use). Please enter our website: www.origo.hk

Remark: For any repair service, please contact and bring with the invoice or receipt to the Service Centre.

Service Centre

ORIGIN MARKETING LIMITED
Unit H,21/F, Reason Group Tower
(nearby 12 Wah Sing Street), 403 Castle Peak Road,
Kwai Chung, N.T., Hong Kong.
Tel: 2156 8238

Office Hours

10.30am - 12:30pm (Mon ~ Fri)
02:30pm - 05:30pm (Mon ~ Fri)
10:30am - 12:30pm (Sat)
(Closed on Sunday and Holiday)

Origin Map

